

FLEET ENGINEERS

1800 EAST KEATING AVENUE
MUSKEGON, MI 49442
PH: 1-800-333-7890 • F: 231-777-2720

Installation Sheet #INS-03029

Master Multi-Mount Installation Instructions

Patent 7,073,804

NOTE: These instructions for installing Master Multi-Mount are intended to be a general guide to help the installer. Because of the large number of possible mounting configurations, the installer is responsible for the installation design and for providing adequate clearance around the tire carrier (i.e. tire clearance, trailer clearance, etc.)

This product may not fit all truck models or types of suspensions. Check truck or trailer manufacturer for suspension travel specifications. Modifications to the brackets and/or the fenders may be required. Any modifications are at the discretion, responsibility and risk of the installer.

- 1) Place Nord-Lock washer (A) and Master Multi-Mount casting washer (B) as shown in **FIGURE 1** with the side with the bevels facing away from the bolt head onto a 5/8" x 6 1/2" bolt (C).
- 2) Insert the bolt assembled in step 1 through the slot in the Master Multi-Mount (D) matching the side with the bevels to the bevels on the washer.

FIGURE 1: EXPLODED VIEW

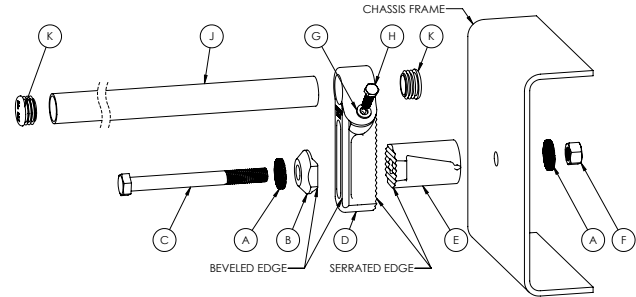

- 3) Slide the Master Multi-Mount Frame Spacer (E) over the bolt, making sure that the serrations of the two parts engage.
NOTE: If additional distance from the frame is needed, it can be gained by using the 3.5" extension set (part #031-01299), not included.
- 4) Insert the bolt through the selected hole in the frame, installing a Nord-Lock washer (A) and a nut (F) onto the bolt. Finger tight at this time.
- 5) Put a 3/8" lock washer (G) on a 3/8" x 1-1/4" bolt (H) and thread it into the clamp portion of the Master Mount (D).
- 6) Slide the Master Multi-Mount Tube (J) through the clamp (D) making sure at least 1/8" of the tube protrudes out the other side, as shown in **FIGURE 2**.
- 7) Make the desired adjustment for offset and rotational position of the Master Multi-Mount. Tighten the bolts to the proper torque, 245 ft. lbs. for the 5/8" bolt (C) and 23 ft. lbs. for the 3/8" bolt (H).
- 8) Install an end cap into each end of the Master Multi-Mount tube per directions supplied.

FIGURE 2: SIDE VIEW

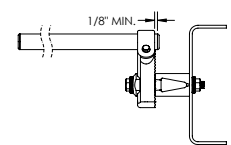

The Master Multi-Mount is now ready for fender installation.