

FLEET ENGINEERS

1800 EAST KEATING AVENUE
MUSKEGON, MI 49442
PH: 1-800-333-7890 • F: 231-777-2720

Installation Sheet #INS-97005

Universal Poly Quarter Fender Assembly Instructions

NOTE:

These installation instructions are intended to be a general guide to help the installer. Because of the large number of possible mounting configurations, the installer is responsible for the ultimate installation design. Any modifications to the product are at the discretion, responsibility and risk of the installer.

COMPONENTS

- 1 – Universal Quarter Fender Sleeve
- 1 – Cross-Tube Mount Tube with Stud Plate Assembly
- 1 – Poly End Cap
- 1 – Support Strap
- 3 – Serrated Flange Nuts
- 1 – Top Flap and mounting hardware (optional)

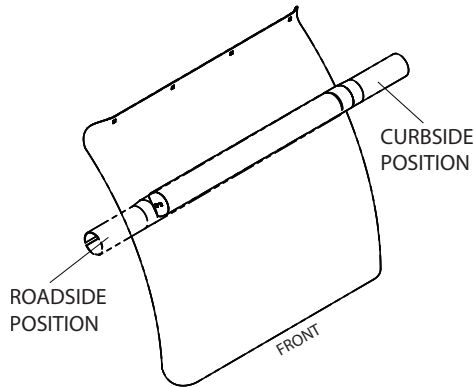

ASSEMBLING THE CROSS TUBE

1. Determine your desired fender position, either roadside or curbside and position the tube across the front of the fender in line with the pre-drilled holes as shown below.

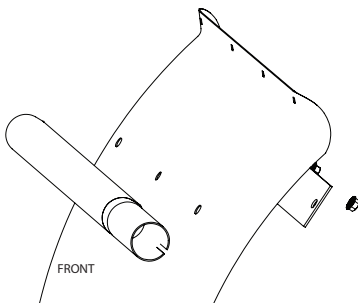

2. Install the support strap on the back side of the fender using (3) 3/8-16 serrated flange nuts. Torque to 23 ft-lbs.

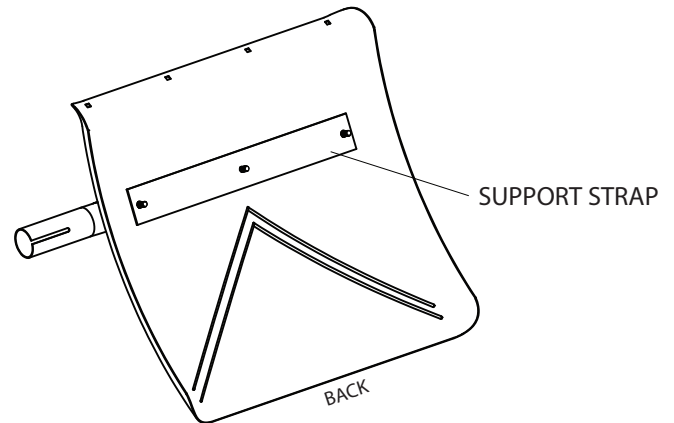

4. Install end cap by carefully centering end cap in tube making sure the cap is not cocked. Use a soft faced hammer or rubber mallet and tap on the outer edge of the cap, moving around the edge in a circular movement. Continue tapping around until the cap is fully seated.

ASSEMBLING THE TOP FLAP (OPTIONAL)

1. Position the top flap with the four pre-drilled holes at the top of the quarter fender as show below.
2. Insert 1/4-20 carriage bolts as shown and install washer and nut from the backside of the fender. Torque to 6 ft-lbs.

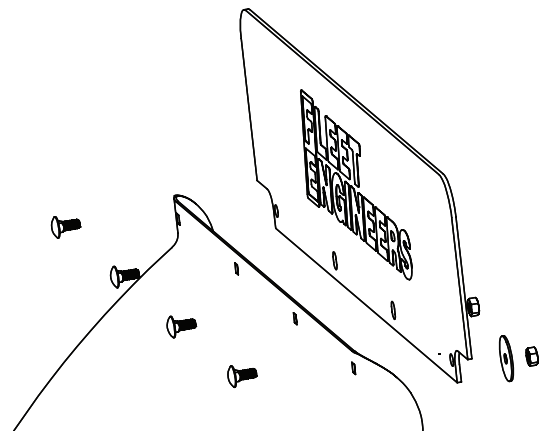

FOR INSTRUCTION ON MOUNTING FENDER TO CHASSIS,
Please see Installation Instruction, INS-97001.
Additional hardware may be required.